

Orbiter

Quick Start Guide



Cetacea

READ BEFORE INSTALLING

For in-depth safety, installation, and operational procedures, read or download the Orbiter Owner's Manual at www.cetaceasound.com.

ORBITER™ SYSTEM CONTENTS

Orbiter Transmitter

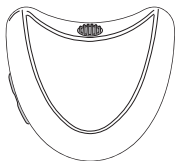

Lanyard Kit

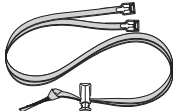

Transmitter Charger



CHARGE UP ORBITER TRANSMITTER

PRIOR TO OPERATION

Please allow two hours of charge prior to first use.



CONNECT ORBITER TO CHARGER

1. Connect the charger to the power connector on the Orbiter.
2. Green LED will begin flashing.
3. Allow for two hours of charge time prior to first use or when Green LED is glowing steady.

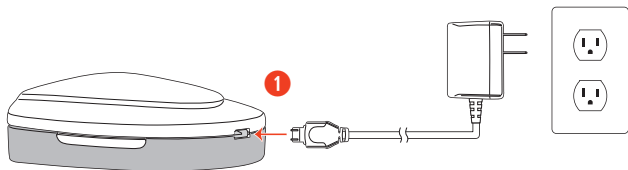

CHARGE UP ORBITER TRANSMITTER (CONT'D)

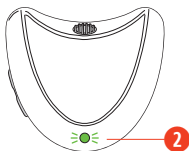

NOTE

The Orbiter has built-in overcharge protection. Once fully charged, the Green LED will cycle between charge (steady) and discharge (blinking).

OPERATE THE ORBITER MIC

REMOVE ORBITER FROM CHARGER PRIOR TO USE

1. Click MASTER CONTROL once for ON.
 - Click again to cycle between ON and MUTE. To turn OFF, push and hold MASTER CONTROL for 4 seconds, then release.
2. Green LED will illuminate on the transmitter while ON.
3. Amber LED will illuminate while connected.
4. Set appropriate volume with VOLUME CONTROL button.

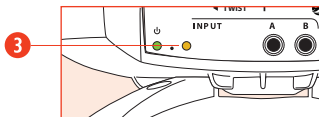
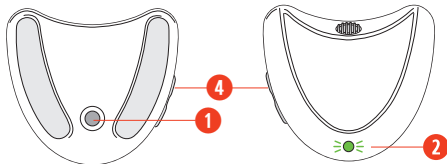

NOTE

The Orbiter will not connect to the receiver while charging. Once charged, disconnect charger and operate pendant as normal.

Orbiter Transmitter

